

- a) Wall
- b) Tile
- c) Shower Pan
- d) Liquid waterproofing
- e) Crack Isolation Tape
- f) Concrete

# transitional & modern linear fusion shower pan surface mounted on concrete installation guide

## Required Components (included)



- a) Linear Shower Pan
  - b) Linear Drain
  - c) Liquid Waterproofing - 2 gallon bucket (covers approx. 100 sq ft with 2 coats)
  - d) Roll of Rubberized Crack Isolation Tape (100 ft)
  - e) 2 - Inside corners of Rubberized Crack Isolation Tape
  - f) Gasket Membrane
- 15 - 2 1/2" screws  
8 - 3/4" screws

**Note:** If you have a larger room and need more waterproofing supplies, please contact us before completing your order.

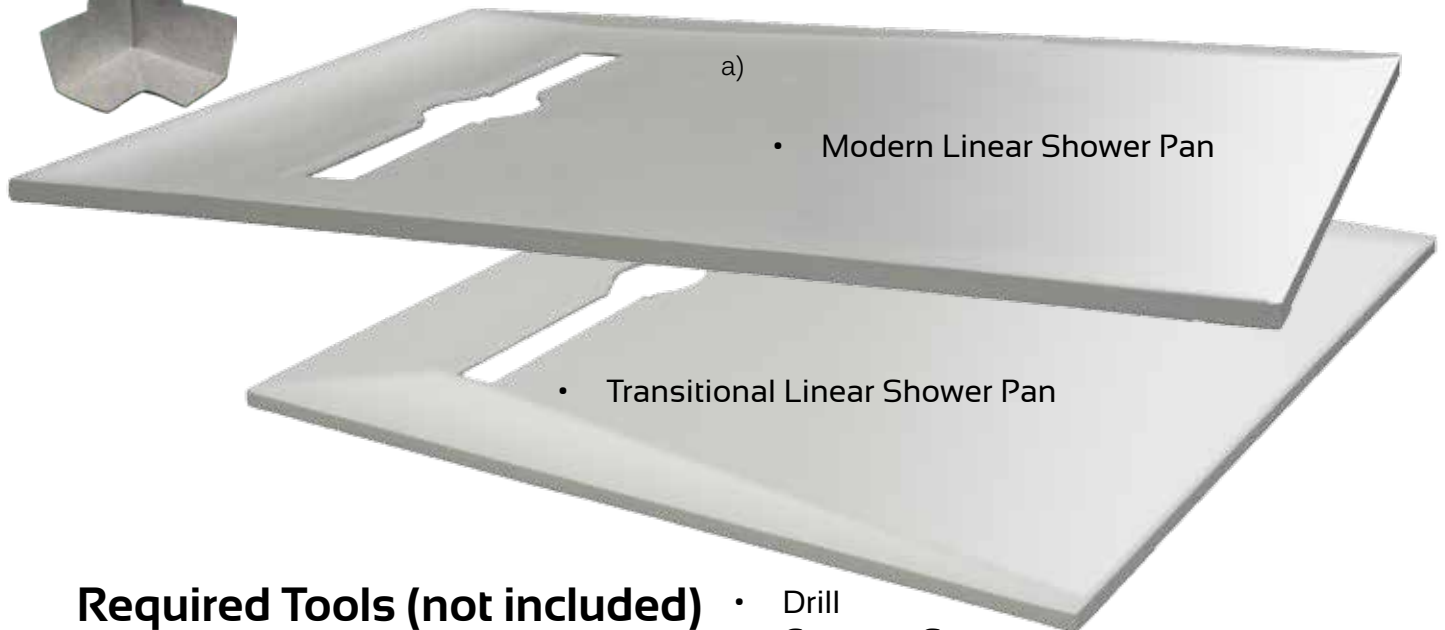

## Required Tools (not included)



- Drill
- Concrete Saw
- Level
- Square
- Caulk Gun
- Hammer
- Utility Knife or Scissors
- Tape Measure
- Paint Rollers
- Paint Brush
- Chisel
- Hammer Drill
- Latex or Acrylic Caulk (**DAP Dynaflex 230**)
- Belt or Orbital Sander / Sandpaper
- Concrete Anchors
- Splash Goggles
- Chemically resistant or impermeable gloves

## Step 1 > > > > > > > >

For optimal performance, it is imperative there is a level surface prior to installation of new Linear Shower Pan. Check existing floor to make sure it is level. If it is not, please correct prior to installation. Place the Linear Shower pan in desired location and check to make sure it is level.

NOTE: Do not apply liquid waterproofing over concrete with moisture content levels exceeding 6lbs/1000 or where surfaces are subject to hydrostatic pressure.



## Step 2 > > > > > > > >

Once the pan is in the desired location, holding the pan steady, trace the inner perimeter of the linear drain cut out. This will mark the location of the linear drain on the concrete, making it easier to cut out in the next step.



## Step 3 > > > > > > > >

Using suitable equipment, and proper safety gear, carefully cut along your line as accurately as possible to a minimum depth of 1/4". It may be easiest to score the concrete approximately every 1" to 2" inside your perimeter line, to make the removal of the concrete more efficient. Now excavate all of the remaining concrete in the marked area.

**Note:** If possible, please check or mark location of existing plumbing and electrical to avoid damaging them.



## Step 4 > > > > > > > >

Place the Linear pan into place. Once the pan is set to the desired location, note the location of drain and remove enough concrete for the installation of the waste pipe, and drain body.



## Step 5 > > > > > > > >

Install the drain in accordance with current plumbing and building codes.



## Step 6 > > > > > > > >

Set the Linear shower pan into place and check to make sure the pan is level. This is important to achieve proper drainage. If you notice any rocking or flexing in the pan, you may need to shim or shave areas.



## Step 7 > > > > > > > >

Important: You must sand the top of the pan lightly with a palm or belt sander to roughen up the surface for proper adhesion of waterproofing.



## Step 8 > > > > > > > >

To prep for permanent installation, remove the Linear shower pan from the surface. Apply a generous amount of construction adhesive to the concrete floor. Place the pan down into position and apply pressure to adhere the pan to the concrete.



## Step 9 > > > > > > >

Again while insuring that your pan has remained level, drill and counter sink holes into the Linear pan. Using cement anchors, attach the pan. Do not aggressively screw and over tighten, as you may force the Linear pan out of level.



## Step 10 > > > > > > >

Using a screed bed, bring the rest of the floor up to the level of the Fusion pan.



## Step 11 > > > > > > >

Check that the Fusion Pan is level on all four sides.

Fill in any gaps around the perimeter of the pan over 1/8" with latex or acrylic caulk.

**Do not use 100% silicone.**



## Step 12 > > > > > > >

Make your final connections to the drain. Make sure connection is snug but do not over tighten.



## Step 13 > > > > > > >

You will now begin waterproofing the wet room.

**BEST PRACTICE:** To achieve the best results, we recommend waterproofing the whole room.

Minimum requirements, shown in these instructions, show you that you only have to waterproof the shower zone, which is 6 ½ feet high and about 2 feet outside of the showering area.



## Step 14 > > > > > > >

Begin taping the wetroom floor at the interior corners of the Fusion Pan using the corner pieces of the crack isolation tape provided. Using a paint brush or trowel, slather liquid waterproofing into corner, press piece into place, then apply liquid waterproofing on top. Make sure to smooth out any creases. Repeat for additional corners.



## Step 15 > > > > > > >

Using the 5" crack isolation tape provided, cut strips of tape to length, to cover all seams (Corner seams, wall/floor seams, pan/floor joint). Put pieces aside.  
If you are creating full wet room, you will need to tape any seams throughout the entire room.  
If you are only waterproofing the shower zone, you will only need to tape the seams up to 2 feet outside the shower area.

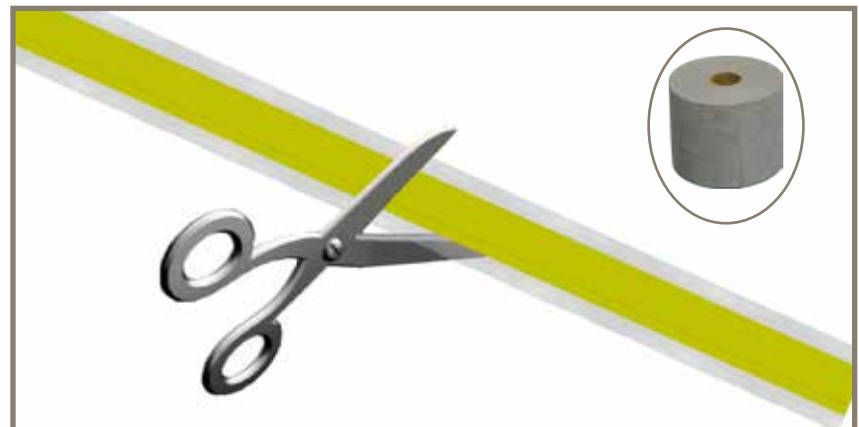

## Step 16 > > > > > > >

Just like you applied the corner pieces, use your cut strips of Crack Insulation Tape to cover all the seams. Again, trowel or paint liquid waterproofing onto seam, press tape into position and coat the top to seal. Make sure to fully cover both sides of the crack isolation tape with the liquid waterproofing product. To make this process more manageable, it is best to work in two foot sections.

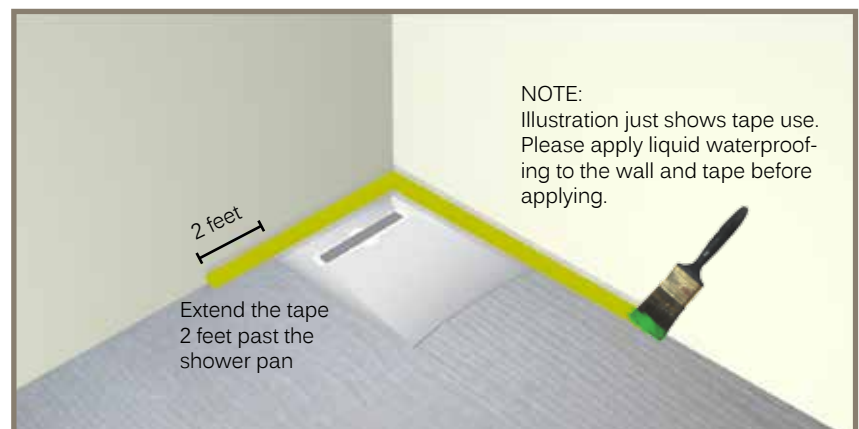

## Step 17 > > > > > > >

Using the 5" crack isolation tape. Overlap all seams of cement board used on either the floors or walls. Overlap the seam where the Fusion pan and cement board meet.

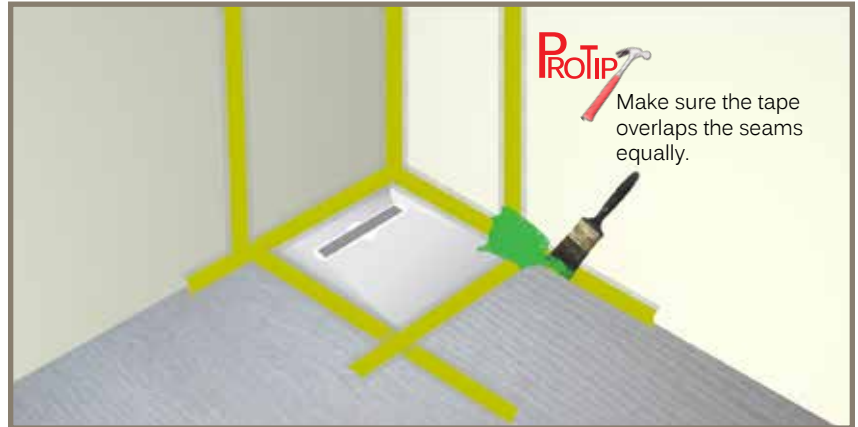

## Step 18 > > > > > > >

**Important: Make sure the linear drain is free of dust and grease.**

Using the provided pre-cut piece of gasket membrane and modified latex thinset, apply thinset to the area where gasket piece will adhere to the drain area. Place over drain adapter flange, making sure to cover all screw holes, and securely press down into flange. Coat top of gasket piece with liquid waterproofing.

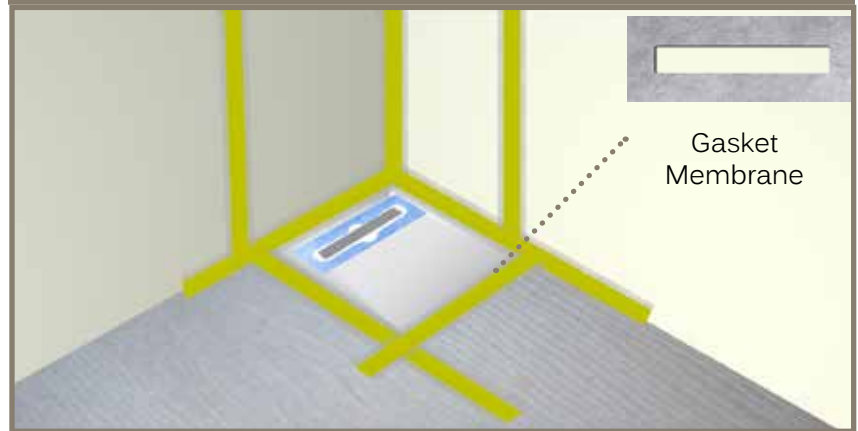

Install the metal tiling guides now, following the instructions in the drain box.

## Step 19 > > > > > > >

Begin the application of the liquid waterproofing membrane. Paint a layer of liquid waterproofing over all taped joints. It is easiest to begin with the walls first and then proceed to the floor area. For consistent application, use a paint roller to apply waterproofing to all surfaces. Allow the waterproofing to dry for about 4 hours. After first coat is dry, re-coat in the opposite direction. If you rolled up and down for the first coat, roll left to right on the second coat.

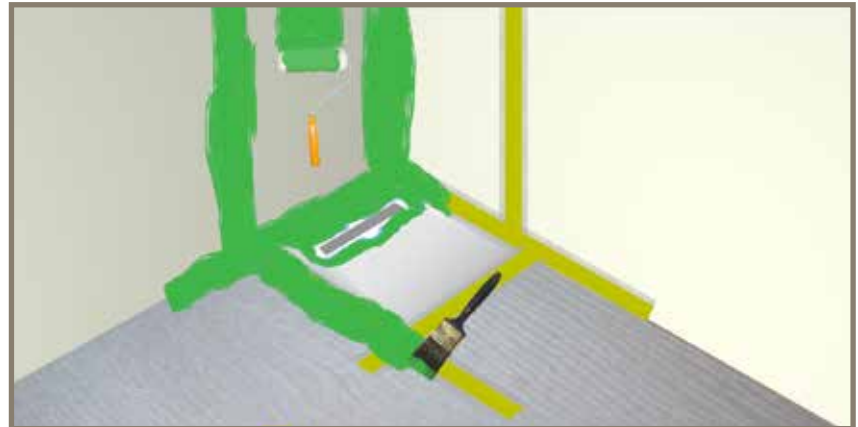

## Step 20 > > > > > > >

Apply two coats of liquid waterproofing to achieve 40 mils. (roughly the thickness of a credit card)

Dry times may be extended on concrete (up to 48 hours in some cases).

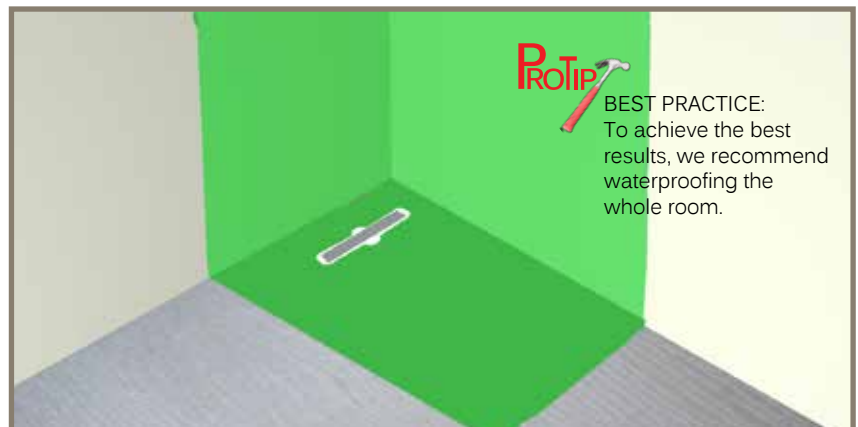

## Best Practice > > > > >

To achieve the best results, we recommend water-proofing the whole room.

The waterproofing must be completely cured before flood testing.

If flood testing, perform test before tiling.

Use modified thinset when placing the tile.

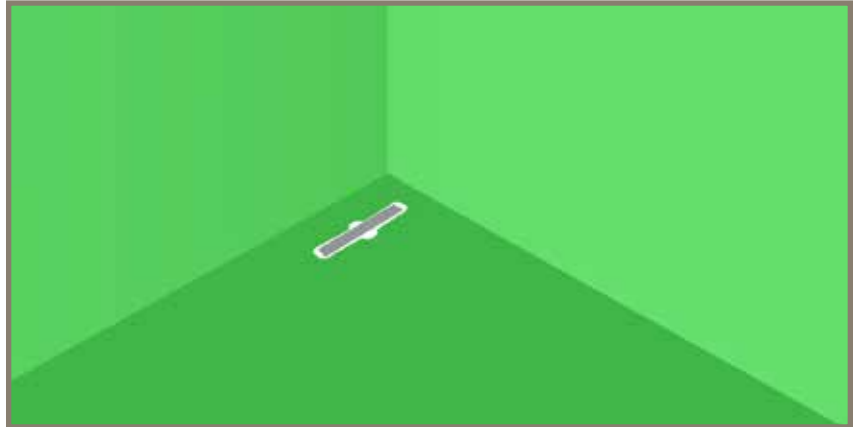

## Step 21 > > > > > > >

To use the tile edging strips, first position them around the perimeter of the drain.

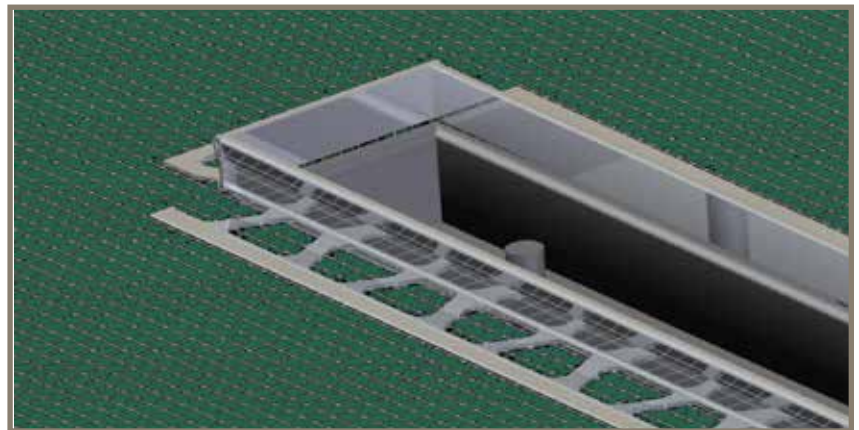

## Step 22 > > > > > > >

Then, lock them in place using the orange clips.

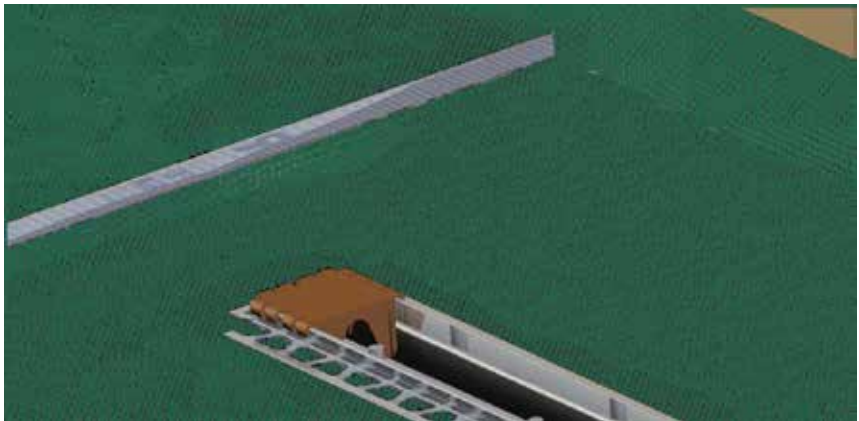

## Step 23 > > > > > > >

You are now ready to tile. Leave an appropriate space for grout along the edging strips.

Use modified thinset when placing the tile.

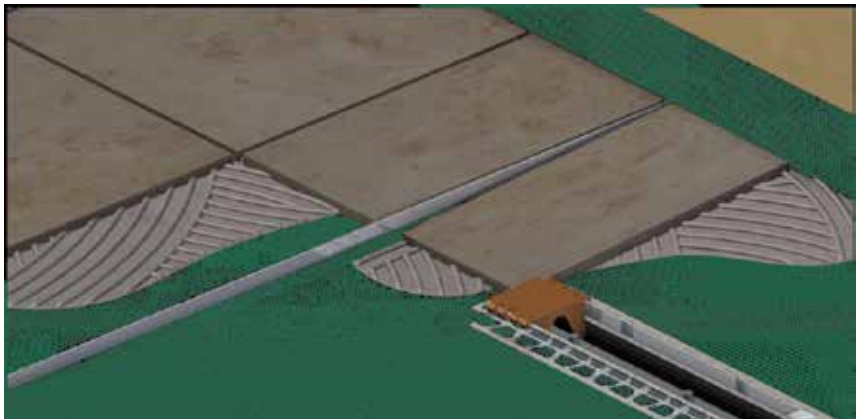



## Step 24 > > > > > > >

The tile spacers should be used if the edging strips are NOT being utilized.

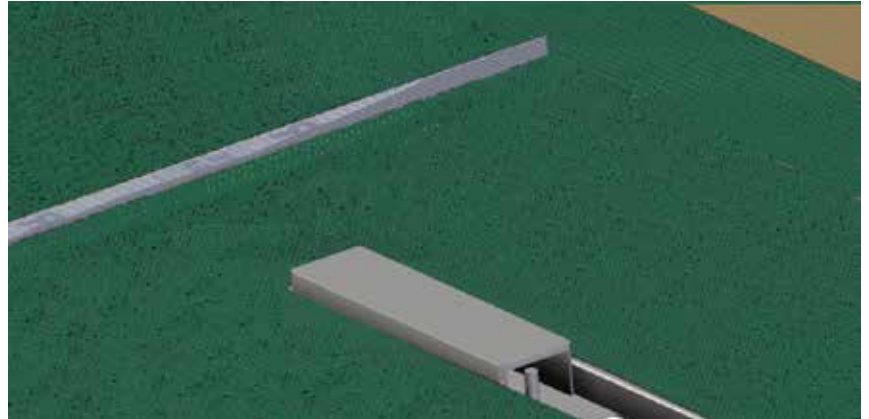

## Step 25 > > > > > > >

Tile the floor up to the faces of the installation spacers.

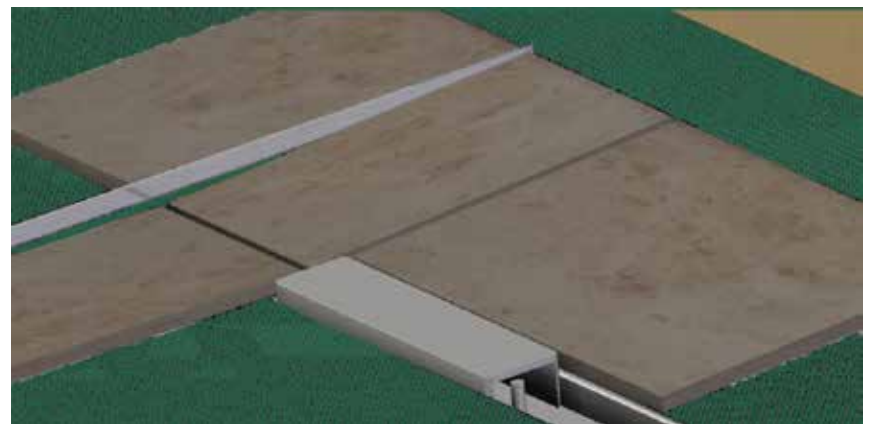

## Step 26 > > > > > > >

If you are using large format tiles with the 4 pitch plane pan, they must be cut diagonally and laid to follow the pitch in the Linear Fusion Pan (From the corners of the grate frame to the corners of the Linear Fusion Pan). Apply the tile adhesive, and lay the tiles in a regular pattern.

After tiling, screw the height adjusters onto the drain so that the cover is level with the tiles.

For the 2 pitch plane Modern Pan, please see the following tiling guide.



## Step 27 > > > > > > >

Place the edging strip on top of the floor/pan up-stand joint, ensuring the strip overhangs slightly, allowing for a 2-3mm grout joint.

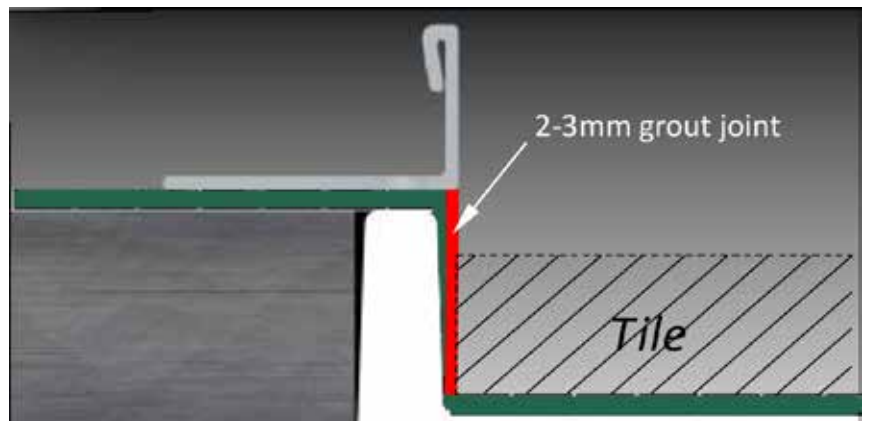

## Step 27 > > > > > >

Lay the tile, allowing for a 2-3mm grout joint next to the edging strip.

Use modified thinset when placing the tile.

