



TRENDING ACCESSIBILITY

Transitional Linear Drain Fusion Pan Technical Data

| | |
|-----------------------|--|
| Thickness | All .87" in height |
| Handing | Universal (not handed) |
| Waste outlet position | Central x 8" from back edge |
| Outlet Size | 2" |
| Sizes Available | 60" x 30" |
| Construction | Multi Layer GRP with solid core and durable Polyester Gel outer surface. |
| Features | Creates reliable and consistent gradient for wet floor showers. Easy installation, no special skills required. Higher flow rates. |
| Installation | Only suitable for tiled floor finishes. Must be fully supported on the underside by minimum .71" thickness plywood. Must be installed with a suitable waterproofing floor membrane. |
| Supplied with | Tile edging kit for edges of drain (up to 0.39" thick tiles). Wet Room Shower System, which includes... Tile Drain, Liquid Waterproofing, Inside Corner Rubberized Crack Isolation Tape, Drain Gasket and Crack Isolation Tape. Also included are screws and installation guide. |

Trending Accessibility reserves the right to change the design of specification without prior notice.
All values are approximate.

Transitional Linear Drain Fusion Pan - FPLT6030

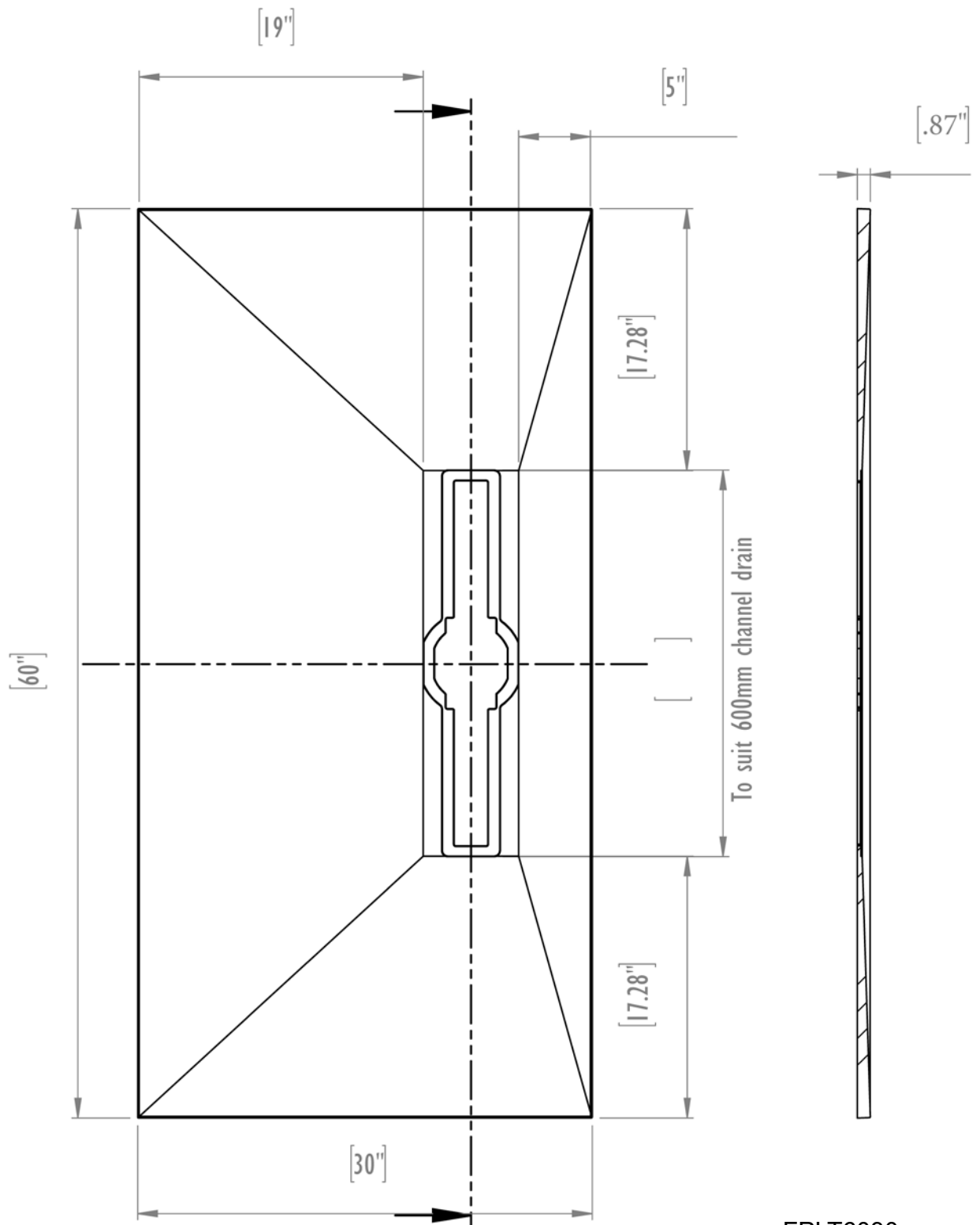

FPLT6030
Trending Accessibility

Trending Accessibility reserves the right to change the design or specification without prior notice.
All dimensions are approximate.